

HEAT CONTROLLER, INC.

REPLACEMENT PARTS MANUAL

Room Air Conditioner:

RADS-253A

RADS-253A EXPLODED VIEW

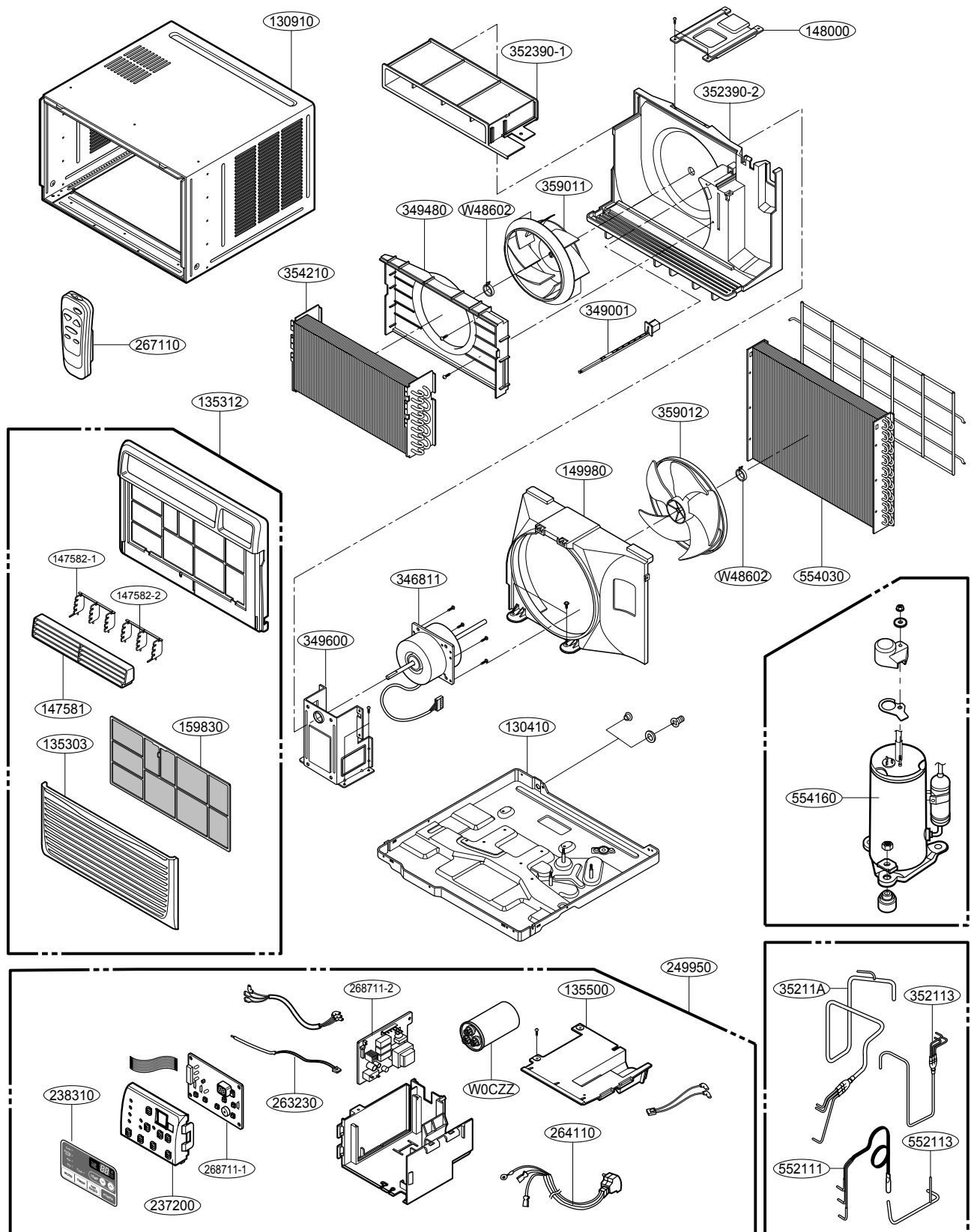

RADS-253A REPLACEMENT PARTS LIST

Part Description	Location No.	Part No.
Base Assembly, Single	130410	3041A10050B
Evaporator Assembly, First	354210	5421A20186F
Condenser Assembly, First	554030	5403A20182C
Guide Assembly, Air	352390-2	5239A20020A
Bracket, Motor	349600	4960A20056A
Motor, AC	346811	4681A20043K
Fan, Turbo	359012	5900A20045B
Shroud	149980	4998A10035A
Fan, Axial	359011	5900A10011A
Clamp, Spring	W48602	3H02932C
Orifice	349480	4948A10024A
Compressor	554160	5416A20045D
Nut, Common	W1NHA	1NHA0801206
Tube Assembly, Suction	35211A	5211A12002F
Tube Assembly, Capillary	552111	AJR72923101
Tube Assembly, Discharge	352113	5211A12003J
Tube Assembly, Capillary	552113	5211A12004A
Guide Assembly, Air	352390-1	5239A20017A
Damper, Vent	349001	4900A20016A
Supporter	148000	4800A20001A
Case Assembly, Control	249950	ABQ35891911
PCB Assembly, Main	268711-2	EBR39283903
Capacitor, Film, Box	W0CZZ	0CZZA20007A
Power Cord Assembly	264110	6411A20056R
Thermistor, NTC	263230	6323A20012C
Panel, Control	237200	3720A10112A
PCB Assembly, Main	268711-1	6871A20604A
Escutcheon	238310	3831A10021U
Cover Assembly, Control (Indoor)	135500	ACQ31027801
Cabinet Assembly, Single	130910	3091A10064A
Grille Assembly, Front	135312	AEB72914501
Grille, Inlet	135303	3530A10210C
Filter Assembly, Air Cleaner	159830	5231A20027A
Louver, Vertical	147582-1	4758A20042A
Louver, Vertical	147582-2	4758A20042B
Louver, Horizontal	147581	4758A30022A
Remote Controller Assembly	267110	6711A20089K

Design, material, performance data and components
subject to change without notice.

HEAT CONTROLLER, INC.

1900 Wellworth Ave., Jackson, MI 49203 ♦ Ph. 517-787-2100 ♦ Fax 517-787-9341

THE QUALITY LEADER IN CONDITIONING AIR

www.heatcontroller.com